

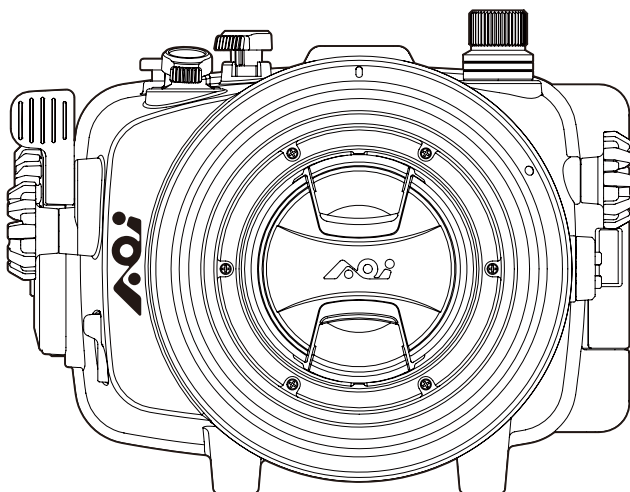

V1.0

# UH-A7CII

## UNDERWATER HOUSING GENERAL GUIDE



Thank you for your purchase of an AOI product. Please read this general guide prior to using the housing. It will provide an overview of how this product can be used for optimal performance. For additional information, please consult your local dealer or write to

***info@aoi-uw.com***

# Contents

Items Included in the Package .....3

Names of the Parts.....4-7

Opening the Housing.....8

Battery Charging.....8

Installing Camera in the Housing.....9-10

Powering on Multi-control Device.....11

Closing the Housing.....11

Perform Vacuum Analyzation.....12-13

Removing Lens Port .....13

Perform Water Leakage Test .....14

Summary of Signal Indicator Color Codes Indication .....14

Specifications.....15

# Items Included in the Package

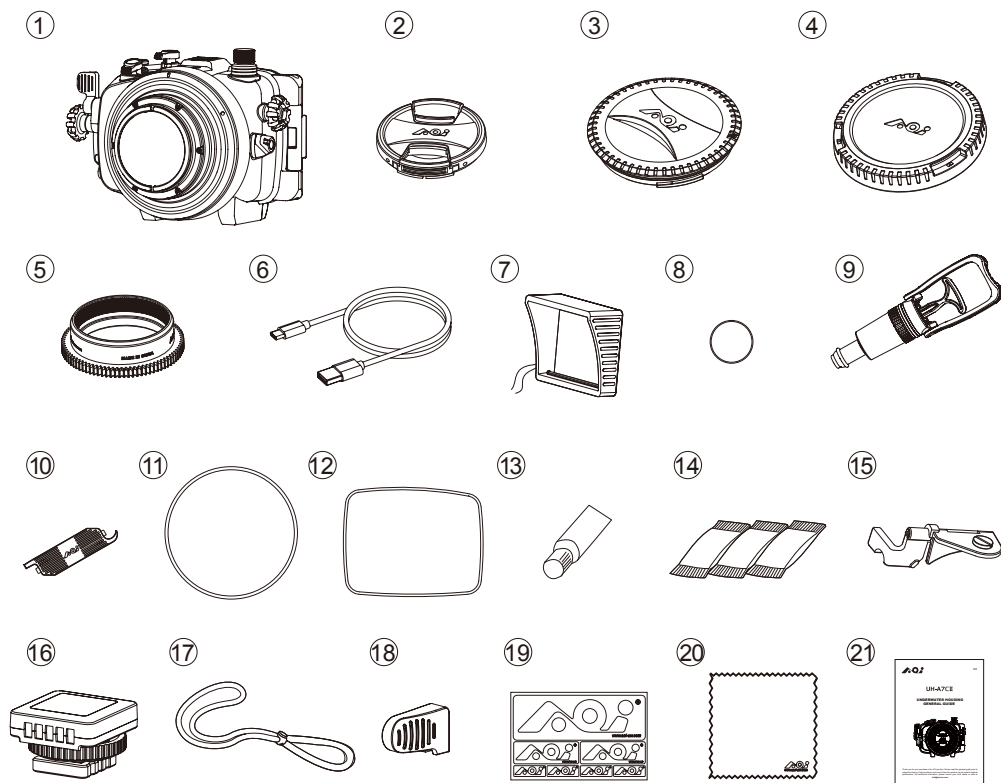

- ① AOI UH-A7IV Housing Body with Flat Port for AX Mount Housing for SONY FE 28-60mm F4~5.6 Lens (AOI FLP-103) x1pc.
- ② Lens Front Cap (AOI LFC-01) x1pc.
- ③ Body Cap for AX Mount Housing (AOI BC-101) x1pc.
- ④ Lens Port Rear Cap for AX Port Mount (AOI LRC-101) x1pc.
- ⑤ Zoom Gear for SONY FE 28-60mm F4-5.6 Lens (AOI LG-SEL-2860) x1pc.
- ⑥ USB Type-C Charging Cable (AOI USBC-02) x1pc.
- ⑦ LCD Hood (AOI LCDH-01) x1pc.
- ⑧ Spare O-Ring for Vacuum Valve Protection Cap (AOI SRVV-01) x1pc.
- ⑨ Vacuum Hand Pump (AOI VP-03) x1pc.
- ⑩ O-ring Remover (AOI ORR-02) x1pc.
- ⑪ Spare Main Seal O-ring (AOI SOR-08) x1pc.
- ⑫ Spare Secondary Seal Ring (AOI SSR-06) x1pc.
- ⑬ Silicone Grease (AOI SIGR-5) x1pc.
- ⑭ Silica Gel (AOI SIGE-3) x1pc.
- ⑮ Camera Lens Release Attachment (AOI CLR-02) x1pc.
- ⑯ Hot Shoe Connector (AOI HSC-03) x1pc.
- ⑰ Lanyard (AOI LYD-01) x1pc.
- ⑱ Extended Shutter Release Lever x1pc.
- ⑲ AOI Logo Sticker
- ⑳ Micro-Fiber Cleaning Cloth (AOI MC-01) x1pc.
- ㉑ Quick Manual

# Names of the Parts

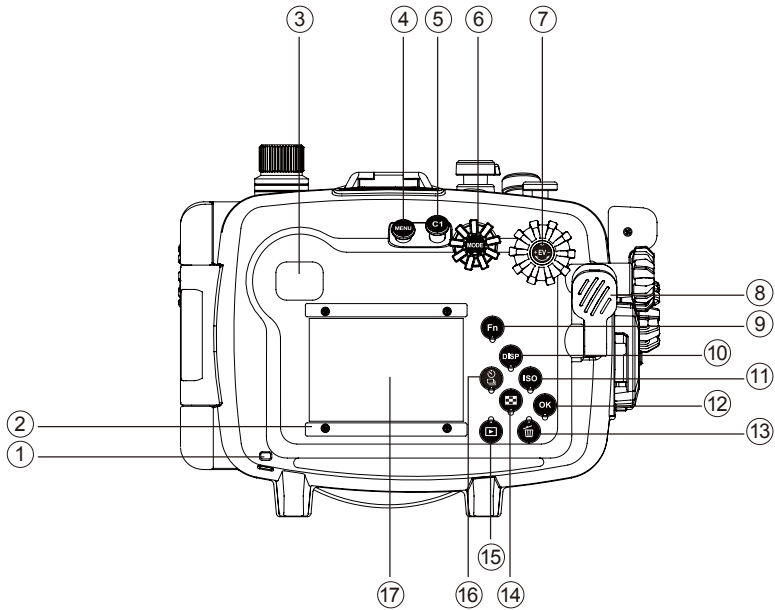



- ① LCD Hood String Eyelet
- ② LCD Monitor Hood Rails
- ③ Viewfinder Window
- ④ **MENU** Button
- ⑤ **C1** Button
- ⑥ **Mode** Dial Knob
- ⑦ **EV** Control Knob
- ⑧ AF-ON Lever
- ⑨ **Fn** Button

- ⑩ ▲/DISP Button
- ⑪ ►/ISO Button
- ⑫ **OK** Button
- ⑬ ⏏ Button
- ⑭ Image Index Button
- ⑮ ▢ Button
- ⑯ ◀/⌂/📷 Button
- ⑰ LCD Monitor Window

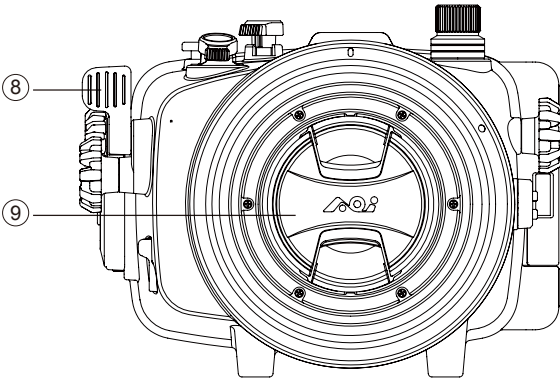
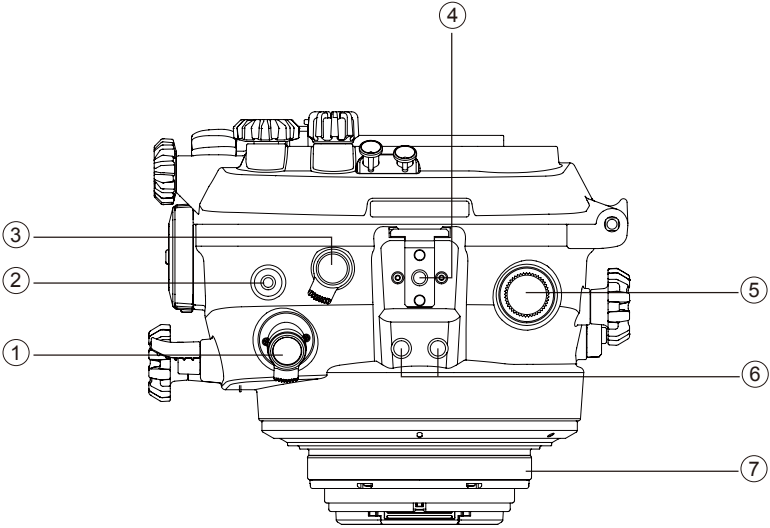

# Names of the Parts



- |  |                           |
|--|---------------------------|
| ① Camera <b>ON/OFF</b> Lever   | ⑥ Fiber Optic Cable Ports |
| ② Movie Button   | ⑦ FE 28-60mm Flat Port    |
| ③  S&Q Dial Lever | ⑧ Shutter Release Lever   |
| ④ Cold Shoe  | ⑨ Lens Front Cap          |
| ⑤ Vacuum Valve   |                           |

# Names of the Parts

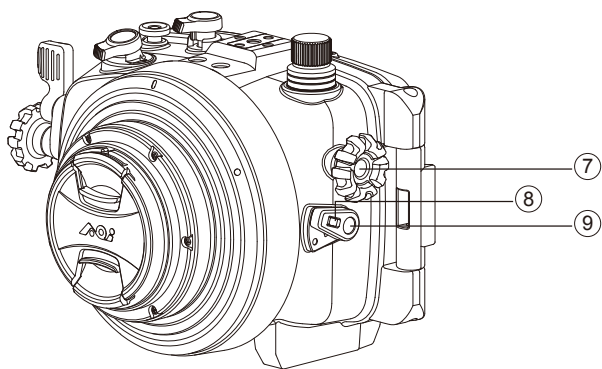
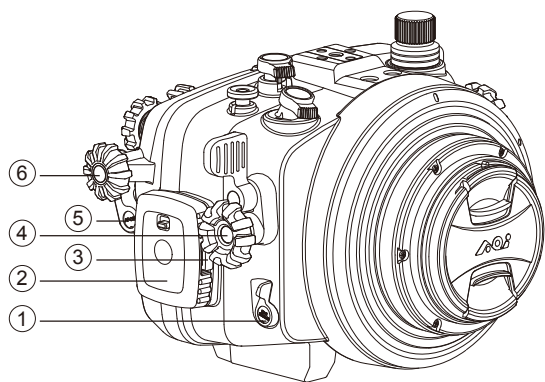

- |                           |   |
|---------------------------|---|
| ① Lens Port Release Lever | ⑥ Rear Dial Control Knob                |
| ② Cam Lock                | ⑦ Lens Gear Control Knob                |
| ③ Cam Lock Release        | ⑧ Security Lock Lens Port Release Lever |
| ④ Front Dial Control Knob | ⑨ Lens Port Release Lever               |
| ⑤ AF-ON Lever             |   |

# Names of the Parts

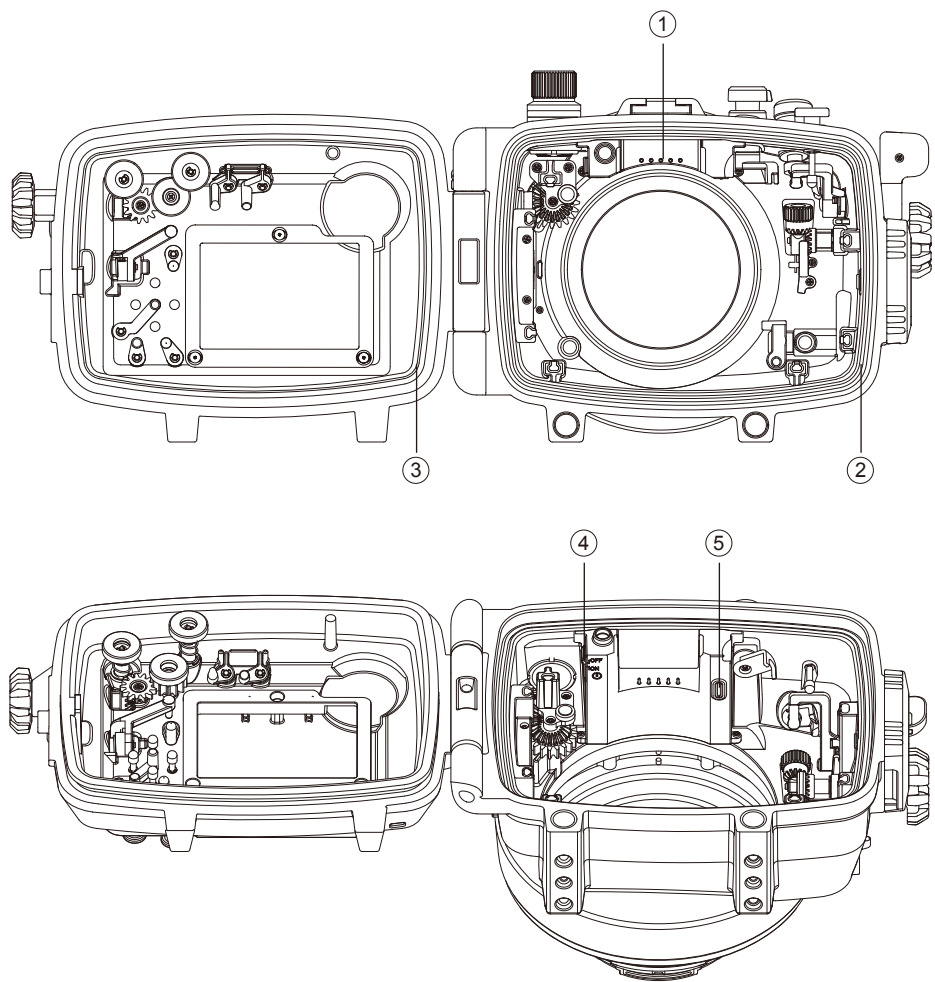

- ① Build-in Strobe Trigger
- ② Secondary Seal Ring
- ③ Main Seal O-ring

- ④ Power ON/OFF Switch Button
- ⑤ USB TYPE-C Charging Port

# Opening the Housing

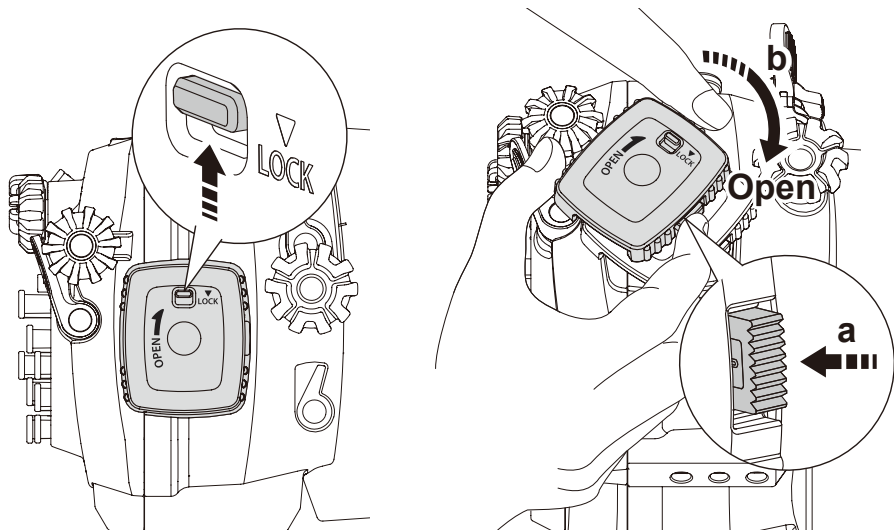

# Battery Charging

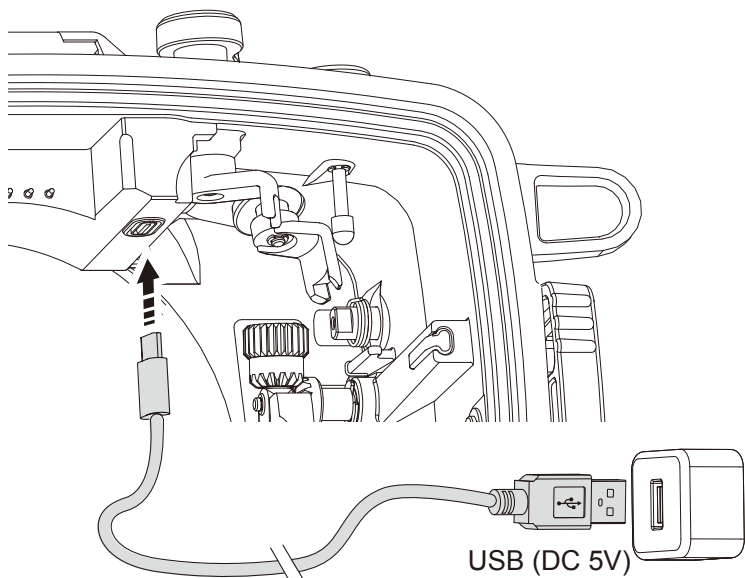

# Installing Camera in the Housing

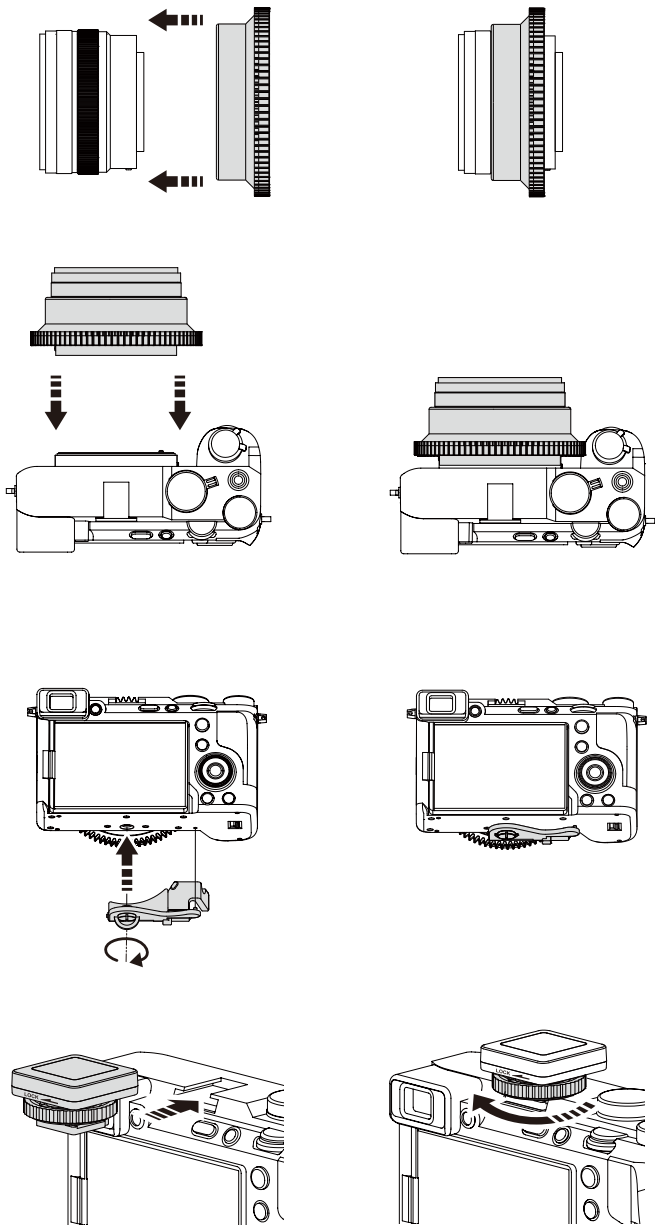

# Installing Camera in the Housing

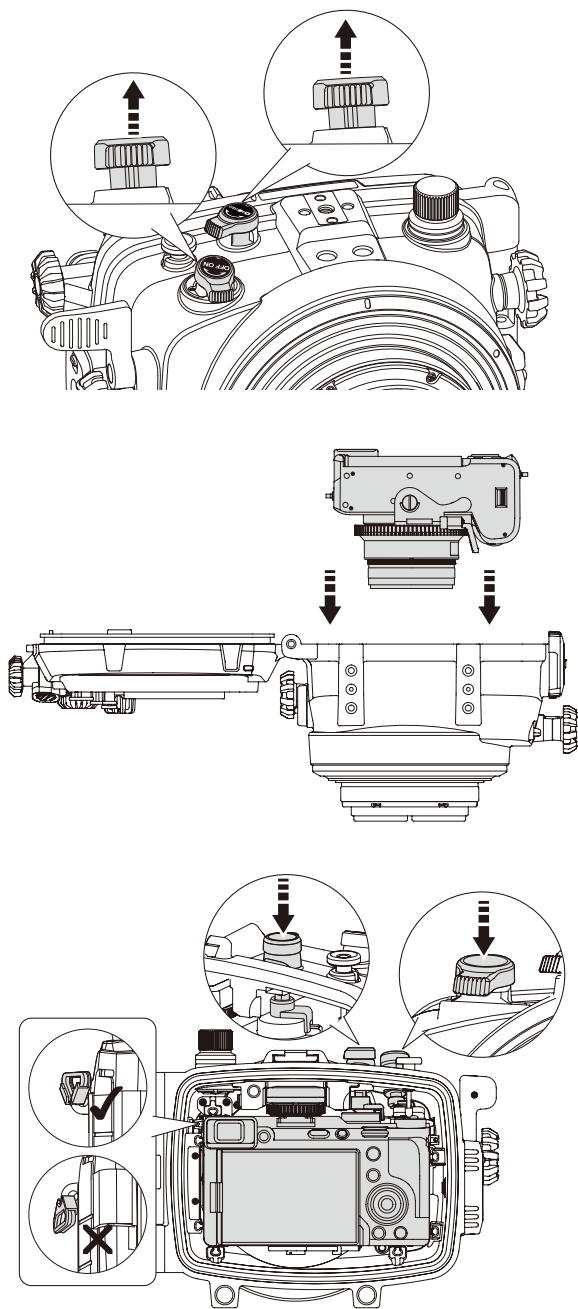

# Powering on Multi-control Device

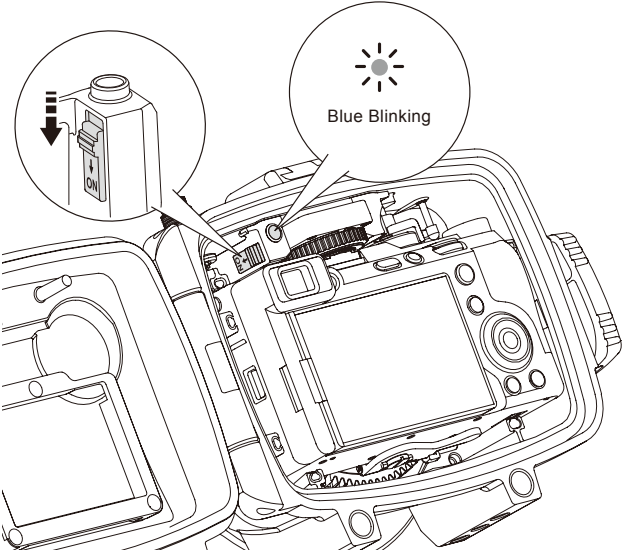

# Closing the Housing

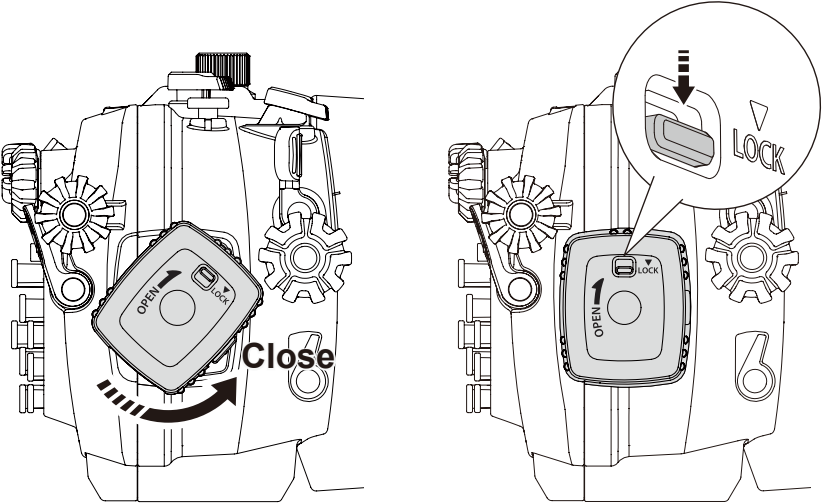

# Perform Vacuum Analyzation

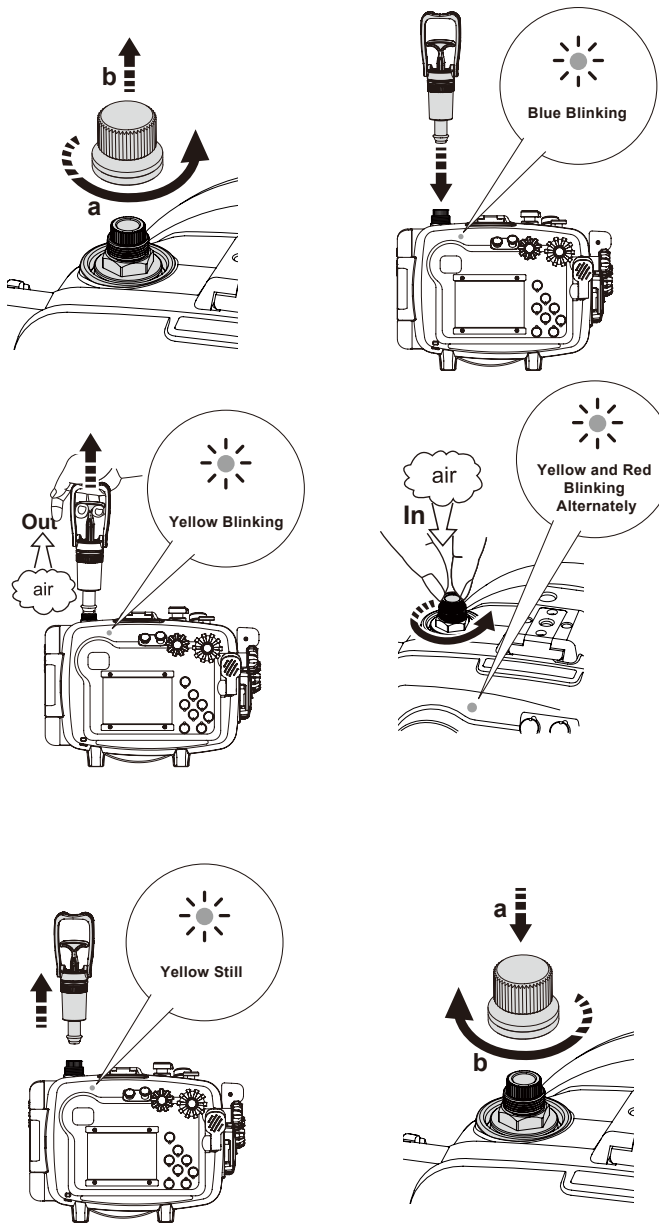



# Perform Vacuum Analyzation

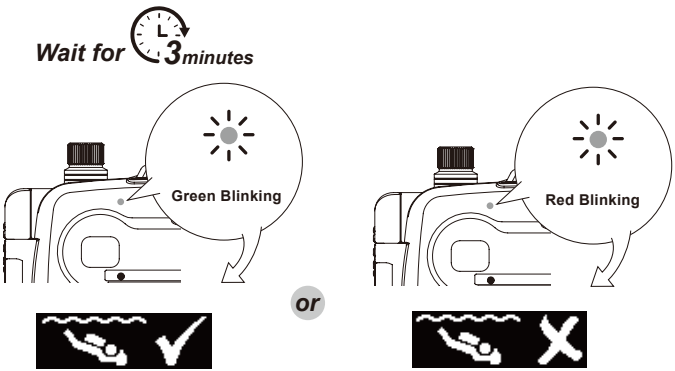

# Removing Lens Port

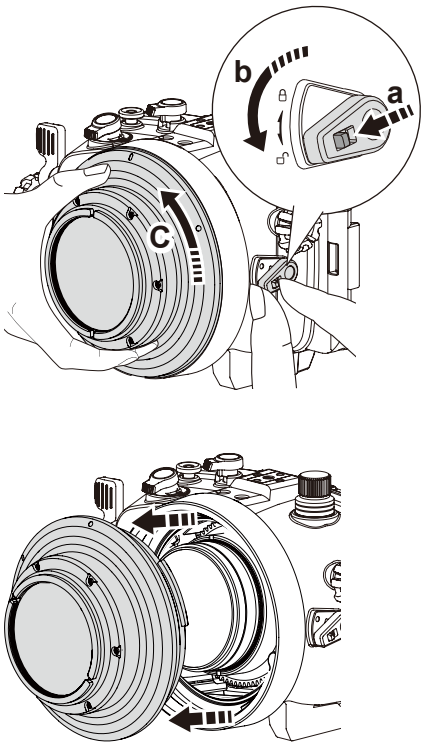

# Perform Water Leakage Test

Once Vacuum Analyzation is completed successfully and Vacuum Valve Protection Cap is secured, review the housing further by checking for water leakage. Submerge it in a shallow water tank. While submerged, activate all the control buttons, control switches, and control knobs in order to have a dynamic test to prove all the sealed moving parts are water sealed properly. If there is no water droplet observed inside the housing after Underwater Dynamic Test, it means the housing is fully watertight. If water leaks into the housing, the water droplets will be detected by the Wet Sensor Strip located in the lowest part of the housing. Multi-control Device will display “LEAKING”, Water Leak Alarm will make “BEEP-BEEP-BEEP” sound.

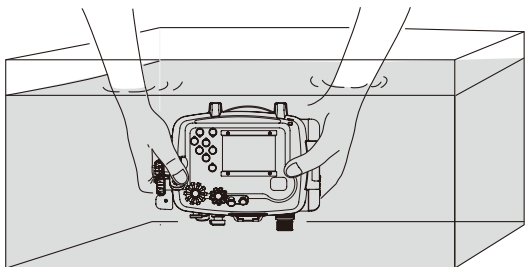

# Summary of Signal Indicator Color Codes Indication

Signal Indicator	Indication	Next Action
Blue Blinking	Ready for Vacuuming	Vacuum Pumping
Yellow Blinking	Vacuum below desired level	Continue pumping
Yellow and Red Blinking alternately	Vacuum above desired level	Twist the red colored Vacuum Release Tip counterclockwise
Yellow Still	Vacuum analyzation in progress	Wait approx. 3 minutes for vacuum analyzation
Green Blinking	Vacuum analyzation test has passed	Ready to go into the water
Red Blinking	Vacuum analyzation test has failed	Inspect the housing for any potential air leakage sources
Red Still + 5 Sec Audible Alarm	Wet Sensor Strip detects water droplet or moisture	Inspect the housing for any potential water leakage sources
Blue or Green 1 Blink / 10 sec.	In Sleeping Mode	Operate the Camera to wake up
Red-Green-Blue Cycle Blinking	System Error	Contact AOI Service Center

# Specifications

MODEL NUMBER		AOI UH-A7CII	
DESCRIPTION		Underwater Housing for SONY ILCE-7CII Camera	
HOUSING COLOR	AOI UH-A7CII-WHT		AOI UH-A7CII-BLK
	White		Black
COMPATIBLE CAMERA MODEL		SONY ILCE-7CR & ILCE-7CII Camera	
MAIN MATERIAL		PC + GF	
DEPTH RATING		60 Meters	
LENS PORT SYSTEM		AX Port System	
MULTI-CONTROL DEVICE	FLASH CONTROL		a) SONY TTL (Auto HSS), b) Manual Flash
	WATER LEAKAGE PROTECTION		Built-in Vacuum Analyzation and Wet Detection System (VWS)
	POWER SOURCE		Built-in Rechargeable Lithium Polymer Battery (3.7V 110mAH)
	BATTERY CHARGING		By USB Charger DC5V, 0.1A (not included) Approx. 1.5 Hours for a full charge
	BATTERY OPERATION TIME		Approx. 2 Days (Based on 3 Dives/Day and 1 Hour/Dive)
DIMENSIONS		197.1mm(L) X 152.7mm(W) X 138.9mm(H)	
WEIGHT		On Land : Approx. 1385.2 g (Only included the Housing Body and Body Cap)	
		Underwater : Approx. -130.0 g (With SONY ILCE-7CII Camera, Camera Batt., FE 28-60mm F4-5.6 Lens, Zoom Gear (AOI LG-SEL-2860), AOI FLP-103 Lens Port and Hot Shoe Connector (AOI HSC-03)	

\*Specifications and Appearances are subject to change without prior notice.